



Owner Manual

Flail Mower

G-EFG



IMPORTANT: Read all instructions before using this attachment

Congratulations on the purchase of your new attachment!

Before you get started, we have provided a helpful space to jot down a few important details:

Model number: G-EFG125 / G-EFG145

Serial number:

Date of purchase:

Factory reference: EFG125 / EFG145

This manual should be considered a permanent part of this attachment and therefore should remain with it even if the attachment is subsequently sold.

The manufacturer continually seeks advancements in its product design and quality. Therefore, while this manual contains the most current product information available at the time of printing, there may be minor discrepancies between your attachment and this manual.

If you have any questions concerning this manual, please consult your local dealer.

Before installation/maintenance, ensure tractor and mower are stationary with the hydraulic lift system in a neutral position, and the ignition key removed. Read and understand this manual fully before operating machinery. Failure to follow all safety standards can result in severe injury or death.

1. Regularly check condition of/service both tractor and mower.
2. Regularly check/tighten all bolts, nuts and screws.
3. Never consume alcohol/drugs while operating machinery.
4. This mower is for use with compact tractors only, within the power range specified, and at the recommended speed at all times.
5. Always keep the PTO output from the tractor at 540 rpm. Reduce the speed when working on hillsides/rough terrain.
6. Only use for the indicated purpose. Do not use to transport personnel or livestock.
7. Always wear protective gloves, ear and eye protection and tie back long hair. Do not wear loose clothing.
8. Always check the immediate area is clear before operating. Check the cutting area is clear of debris that can cause equipment damage.
9. Keep spectators at a safe distance.
10. Do not run the engine in an enclosed area.
11. Do not leave the machine unattended while operating.
12. Do not touch moving parts. Keep hands and feet away from rotating blades.
13. Stop the engine if excessive vibration occurs.
14. When travelling, keep the PTO turned off and the mower in a transport position.
15. Ensure the engine is switched off before any maintenance. Be aware components can be hot after operation.
16. Pay attention to any sharp/pointed parts when servicing.
17. Always repair/replace any defective parts.
18. Do not modify the mower in any way as this may impair the operation and overall safety.

Mower Pre-use Checks

Upon receipt of your new mower and again within the first 4 hours of use (the 'shake in' period), we recommend the following:

1. Check/tighten all bolts, nuts and screws (and those securing blades).
2. Check the tension of any belt(s), and adjust if required.
3. Apply grease to grease points if required.
4. Check gear oil level, top-up if required but do not overfill.

Be aware components can be hot after operation.

Tractor Pre-use Checks

1. Check the mower is properly attached to the tractor. Ensure secure pins are used on the linkage mounting pins.
2. Add extra weights to the front of the tractor (or wheel weights) if required.
3. Check the tractor PTO turns freely, and the mower's PTO drive shaft can extend sufficiently. Apply grease to the PTO drive shaft.
4. Frequently check the condition of the chain on the PTO drive shaft. Keep all universal joints and protective parts in a good condition.
5. Before installing, the tractor and mower should be stationary, remove the key from the ignition.
6. Install and secure all safety guards, doors and covers before operating.
7. Bystanders should leave the immediate area before connecting the drive from the tractor.

Post-use Regular Checks

1. Check blades, belts and wearing parts. Ensure they are not damaged and blades are secure in their mounts. Repair or replace as required.

Safety Information.....page 3-4

Specifications.....page 6

Installation Overview.....page 7

Resizing the PTO Drive Shaft.....page 8

Setting Cut Height.....page 9

Drive Belt Adjustment.....page 10-11

Gearbox Maintenance.....page 12

Servicing & Maintenance.....page 13



Parts Diagram 1 & Parts List page 14-16

Parts Diagram 2 & Parts List page 18-19

Specifications

The Flail Mower G-EFG model is a multi-purpose attachment, ideal for cutting thick grass, under growth, light vine mulching, weed control, vegetable and pasture topping.

The G-EFG cutting height is controlled by adjustable skids with heavy duty hammer blades driven by belts. Fitted with strong safety flaps to prevent debris being thrown and a support leg for storage.

Model	Width (cm)	Depth (cm)	Height (cm)	Working Width (cm)			
G-EFG125	140	85	95	125	20	16-35 hp	260
G-EFG145	160	85	95	145	24	25-40 hp	290

Installation Overview

Before installation/maintenance, the tractor and mower should be stationary with the hydraulic lift system in a neutral position and the ignition key removed.

On a flat area of ground lower the three point linkage on the tractor to its lowest position. Attach the mower to the tractor using the three point linkage pins and lynch pins:

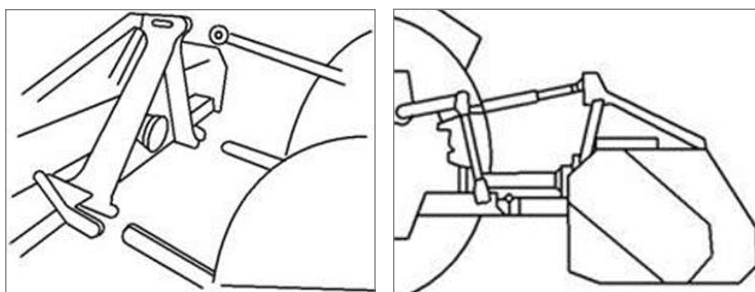

With the mower's rear roller on the ground, adjust the length of the top link arm so that the skids at the side of the mower are parallel with the ground.

To set correct cutting height, rotate the blade rotor by hand, so they hang vertically towards the ground. There should be a clearance of at least 5cm between the blades and the ground. To increase the blade clearance and cutting height for rough ground or long grass, raise the tractor's hydraulic lift arm or adjust the rear roller and skids on the mower.

The working speed of the mower should be at a walking pace of 2 to 5 mph. Overgrown grass/weeds should be cut at a much slower pace to avoid damage to the mower.

Check the oil level in the gearbox, the tension of the drive belts and tightness of all bolts, nuts and screws. Lubricate all grease points including PTO drive shaft. Attach the PTO drive shaft and ensure locking pin is secure on both the tractor and mower sides. Attach the chain to a secure point on the tractor/mower. Ensure all safety guards are in place. **Always replace worn or damaged PTO drive shafts.**

Operate the mower in a low gear range, keep the PTO output at 540 rpm.

Resizing the PTO Drive Shaft

Before installation/maintenance, the tractor and mower should be stationary, the hydraulic lift system in a neutral position and the ignition key removed.

A PTO drive shaft will often need re-sizing to fit the tractor. To resize, attach the mower to the tractor without the PTO drive shaft, raise the linkage so the PTO drive shaft is level/horizontal. Measure the length between the tractor's PTO and the PTO drive shaft. If the compressed (closed) PTO drive shaft length exceeds the one measured in diagram 7 below, then the driveline will need to be cut as per instructions below.

If you are not confident in carrying out this work please contact your local supplier or mechanic.

1. Remove PTO drive shaft shielding.

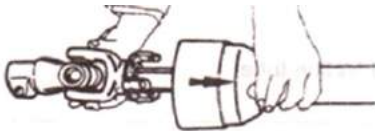

2. Cut the driveline tubes to equal lengths.

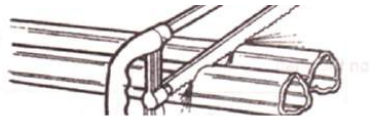

3. Use a file to smooth edges of the driveline tube and clear away all fillings from the tubes.



4. Cut the guard tubes to the same length as the driveline tubes.



5. Grease the internal driveline tube.

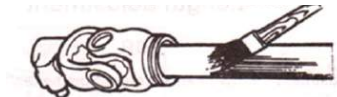

6. Fit the guard on the shaft.

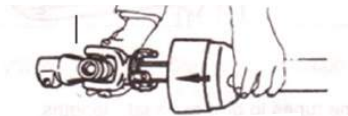

7. Ensure that the length allows for at least 16cm (1/3) of overlap

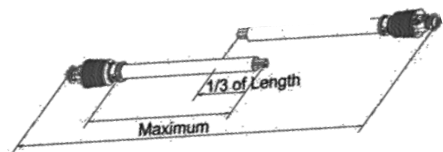

Before installation/maintenance, the tractor and mower should be stationary with the hydraulic lift system in a neutral position and the ignition key removed.

To increase the blade clearance and cutting height for rough ground or long grass, either raise the tractor's hydraulic lift arm or adjust the rear roller and skids on the mower.

Rear Roller Adjustment:

1. Loosen bolt (2)
2. Remove bolt (1) on both sides of the mower.
3. Adjust the roller by aligning the selected hole in the roller support bracket at position (1). (Using the hole closest to the ground gives the highest working height).
4. Put bolt (1) into the selected hole and re-tighten bolts (1) and (2).

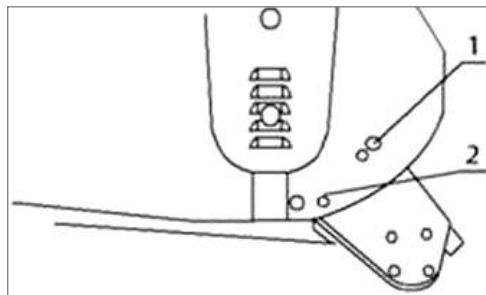

Skid Adjustment: Loosen bolts (3) on the skids (front and back on both sides). Move

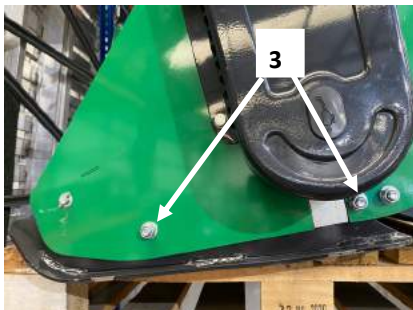

Drive Belt Adjustment

Before installation/maintenance, the tractor and mower should be stationary with the hydraulic lift system in a neutral position and the ignition key removed.

To achieve the correct belt tension, the belt must be deflected by the belt thickness approx. 1cm at the centre point between the pulleys. Always align the gearbox so the PTO drive shaft is parallel with the body. Use a straight edge to ensure the belt pulleys are in line and running true.



Drive Belt Adjustment (continued)

Check drive belts regularly and replace if damaged or worn. To check the belt condition and tension:

1. Loosen screw **(A)** and **(B)** that locks the support shaft and loosen counter nut **(C)**.
2. Loosen the screws that lock the gear box on the mounting plate **(D)**.
3. Adjust the drive belt tension using bolt and nut **(C)**.
4. Re-tighten the gear box mounting plate screws **(D)**.
5. Tighten screw **(A)** and **(B)** on the support shaft.
6. Replace the belt guard.

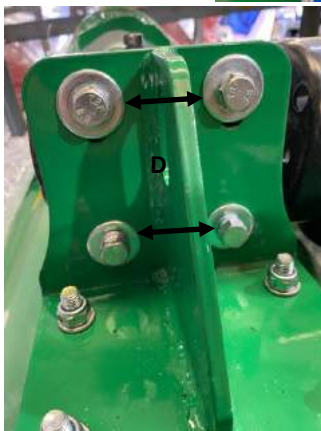
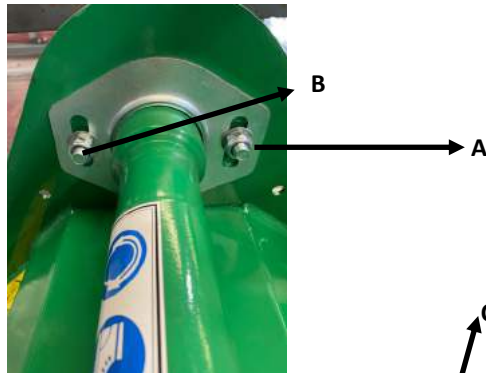

Gearbox Maintenance

Gear Oil Grade	80w90 gear oil for all conditions (or equivalent)
Gearbox Oil Level	Approx. 0.5 litres to level plug
First Oil Change	50 hours use
Oil Change Frequency	250 hours/yearly (whichever is first)

Oil Level Check: Check gear oil level when the unit is cold and the mower is level. Remove the level plug (1) from the side of the gearbox. Remove the filler/breather

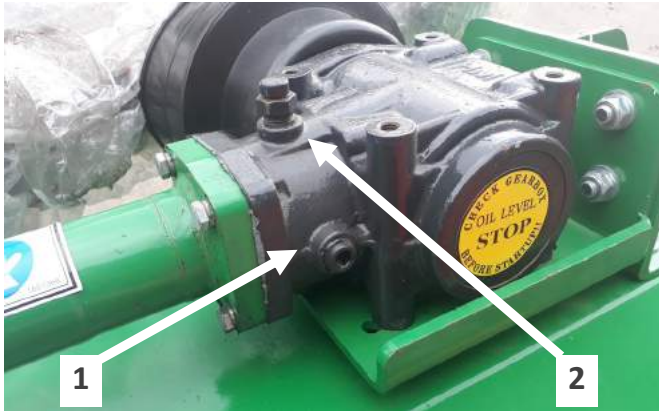

The oil level should reach the level plug (1). Top-up the oil through (2) if required. Avoid over filling as this may cause excess pressure and oil leaks.

Replace the level and filler/breather plugs (be careful not to over tighten as this may cause a pressure build-up in the gearbox).

Oil Change: Remove level plug (1) and filler/breather plug (2). Use an oil pump to extract all oil and debris from the gearbox. Fill with oil to the level plug, and replace

Oil Change #1	Oil Change #2	Oil Change #3	Oil Change #4	Oil Change #5	Oil Change #6
/ /	/ /	/ /	/ /	/ /	/ /

Servicing & Maintenance

Before installation/maintenance, the tractor and mower should be stationary with the hydraulic lift system in a neutral position and the ignition key removed.

Greasing & Lubrication:

Use a clean cloth to wipe grease nipples before greasing to avoid injecting any dirt. Press grease into each nipple three to five times. For best results use a hand-held grease gun. If nipples will not take the grease, thoroughly clean the passageway. Replace or repair any broken grease points immediately. **Store all lubricants away from excessive heat, dust, moisture and contaminants.**

Regularly check the condition of **blades**, wear gloves and take care when handling.

Grease Type:	Multi-purpose lithium based grease (EP1 or EP2 recommended)
Grease Frequency:	Check every 4-8 hours (top-up if required)
Grease Points:	Bearings on the blade rotor x 2 quantity
	Bearings on the rear roller x 2 quantity
	PTO drive shaft x 2 quantity

Replace blades if worn/broken and ensure they are balanced to avoid excessive vibration. Check the condition of **belts**, replace if worn or frayed. Adjust the belt tension if required.

Check the **bearings** on the blade rotor and rear roller. If the oil seals are damaged debris may enter. Clean and replace with new bearings if required. Run the mower without a load for 3-5 minutes to check bearings are operating smoothly. Check the condition of the side **skids**, replace if worn.

Check the condition of **PTO drive shaft**, immediately replace if worn or damaged.

Regularly check oil levels and top-up/replace when required. Ensure the mower deck is clean, remove any debris from moving parts. Do not spray water on bearings if cleaning with a high-pressure washer. Re-paint any damaged paintwork to prevent corrosion. Store the mower in a dry, level area. Support the frame if necessary.

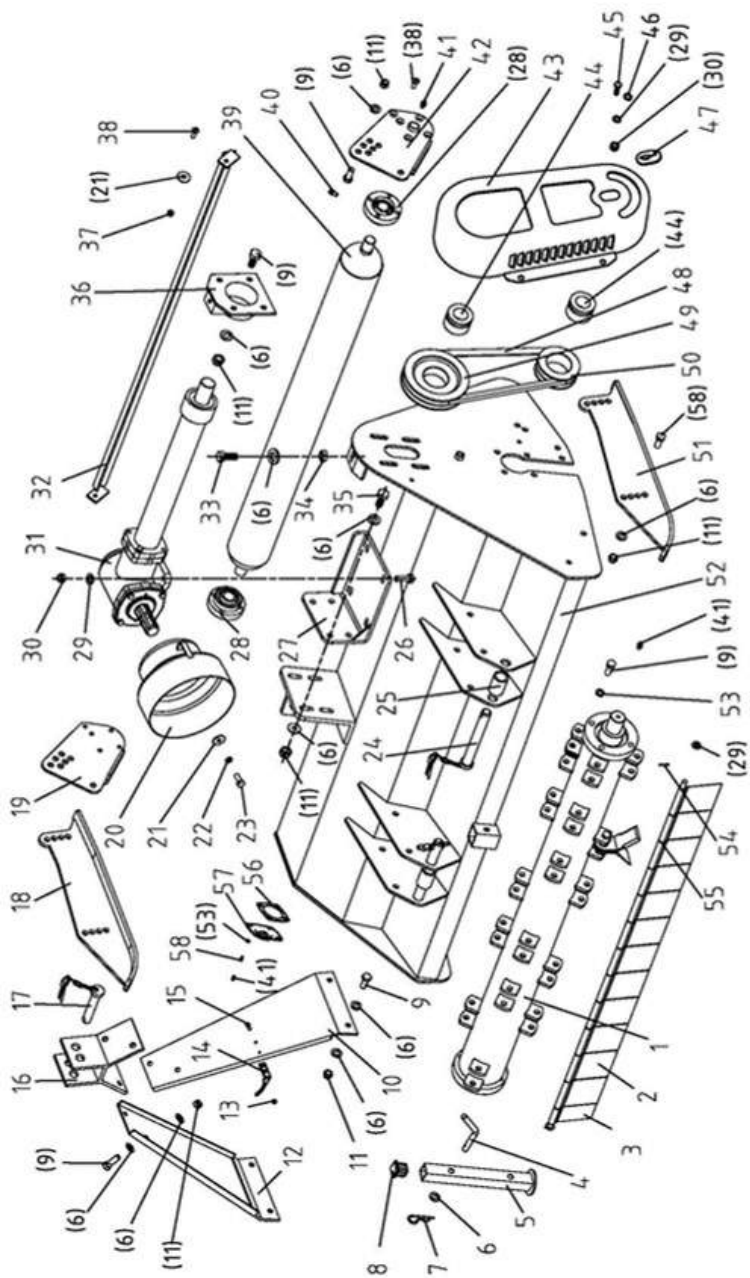

Diag. No.	Ref No.	Part No.	Part Description	Qty
1-4	801160021	EFG120.013	Blade shaft (125)	1
1-6	801180006	EFG140.013	Blade shaft (145)	1
2	700920108	EF100.00.122	Wide board fender	13
3	700920107	EF100.00.121	Spare board fender	1
4	800920101	EF100.00.111A	Square pin	1
5	800920053	EF100.00.027	Supporting leg	1
6	506010057	GB97.1-12	Washer 12	41
7			R clip	1
8	700920105	EF100.00.117	End cap	1
9	501011126	GB5783-M12X30	Bolt M12 x 30	12
10-1	800920037	EF80.00.020	Right A-frame plate (125-145)	1
11	503010763	DIN985-M12	Lock nut M12	54
12-1	800920030	EF80.00.016	Left A-frame plate (125-145)	1
13	503010759	DIN985-M6	Locknut M6	2
14	701110026	EFR105.105	Linkage rest	1
15	501011090	GB5783-M6X25	Bolt M6 x 25	2
16	800920033	EF100.00.018	Upper A-frame bracket	1
17	803440016	EF100.00.019	Top link pin	1
18	801240019	EFGC120.013	Left skid	1
19	801160004	EFG120.018	Left roller supporting plate	1
20	700920127	EF100.00.115	PTO cover	1
21	506010055	GB97.1-8	Washer 8	4
22	506030035	GB93-8	Washer 8	2
23	501011098	GB5783-M8X16	Bolt M8 x 16	2
24	800920021	EF100.00.014	Lower link pin	2
25	700920096	EF100.00.106	Linkage spacer bush	2
26	501011114	GB5783-M10X35	Bolt M10 x 35	4
27	801160027	EFG120.016	Gearbox seat	1
28	511040007	EF100.00.012	Roller bearing UC205	2
29	506010056	GB97.1-10	Washer 10	8

Diag. No.	Ref No.	Part No.	Part Description	Qty
31-1	805380112	RK90.019	Transmission box	1
31-2	805380110	RK120.019	Transmission box	1
31-3	805380114	RK130.019	Transmission box	1
32-4	801160030	EFG120.024	Scraper (125)	1
32-6	801180008	EFG140.024	Scraper (145)	1
33	501011134	GB5783-M12X70	Bolt M12 x 70	1
34	503010100	GB6172.1-M12	Nut M12	1
35	501011128	GB5783-M12X40	Bolt M12 x 40	8
36	801160023	EFG120.015	Straining ring	1
37	503010761	DIN985-M8	Lock nut M8	2
38	501030185	GB70.3-M8X25	Sunk screw M8 x 25	10
39-4	801160017	EFG120.012	Roller (125)	1
39-6	801180004	EFG140.012	Roller (145)	1
40	509010007	GB1152-M6	Grease nipple M6	2
41	509010008	GB1152-M8X1	Grease cup M8 x 1	4
42	801160001	EFG120.017	Right roller supporting plate	1
43	701250006	EFGC120.111	Belt cover (H=100)	1
44	515010001	REACH04-35X60	Power bush taper lock	2
45	501011112	GB5783-M10X25	M10 x 25 bolt	4
46	506030036	GB93-10	Spring washer 10	1
47	701240046	EFGC120.138	Grease cap	1
48	514010002	17X940	Belt B991	3
49-2	701160007	EFG120.106A	Big belt pulley (three grooves)	1
50-2	701160006	EFG120.105A	Big belt pulley (three grooves)	1
51	801240022	EFGC120.014	Right skid	1
52-4	801160008	EFG120.011	Main body (125)	1
52-6	801180001	EFG140.011	Main body (145)	1
53	506030037	GB93-12	Washer 12	8
54	508011473	GB879.1-4X25	Elastic cylindrical pin 4 x 25	2
55-4	700960009	EF120.00.123	Rod (125)	1
55-6	700980005	EF140.00.123	Rod (145)	1
56	701520010	EFG120.169	Paper gasket	1
57	701520006	EFG120.168	Cap	1
58	501011127	GB5783-M12X35	Bolt M12 x 35	8

Notes

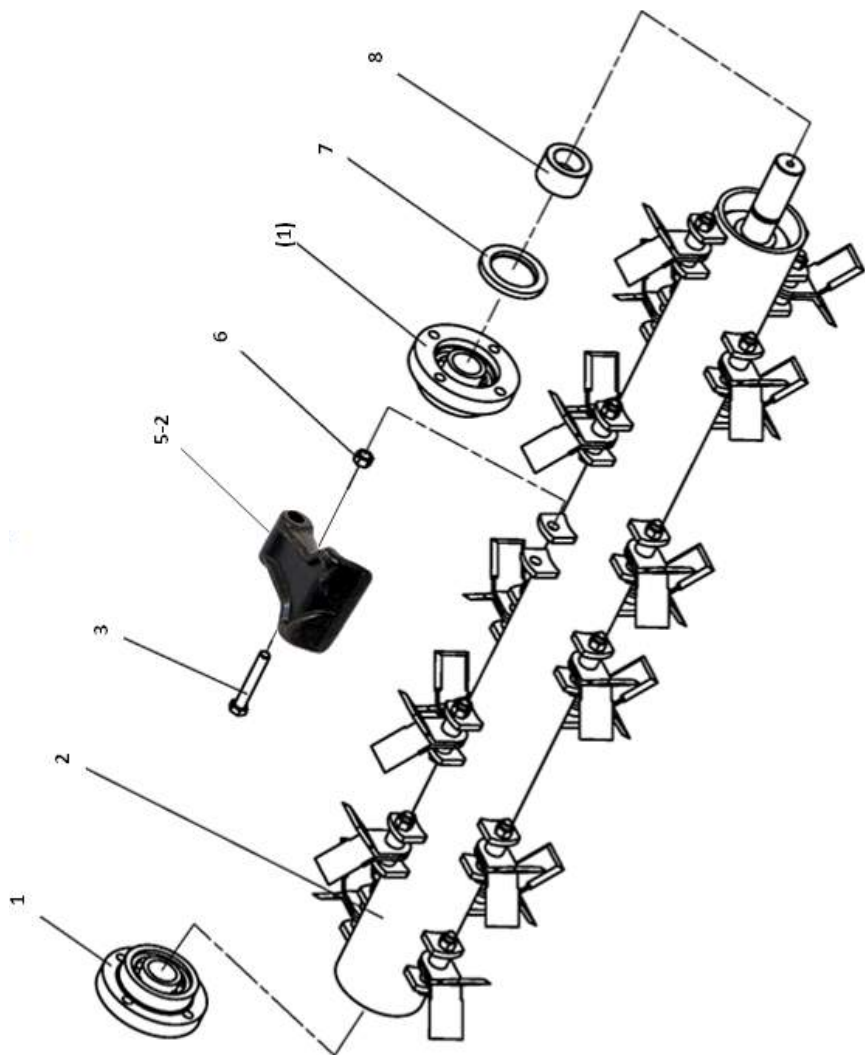

Parts List for Diagram 2

Diag. No.	Ref No.	Part No.	Part Description	Qty
1	511040032	UC207	Rotor bearing 207	2
2-4	801160021	EFG120.013	Blade rotor 125	1
2-6	801180006	EFG140.013	Blade rotor 145	1
3	501014721	GB5785-M12X1.5X78	Blade bolt M12 x 1.5 x 78	20
5-2	701140011	EF100.00.102B	Hammer Blade	20
6	503010738	DIN985-M12X1.5	Blade nut M12 x 1.5	20
7	510020417	GB13871-FB-55X80X8	Seal FB55 x 80 x 8	1
8-1	705380013	RK120.109	Bush 125 (L=33)	1
8-2	705380014	RK120.109A	Bush 145 (L=48)	1

